

OLD PLANK ROAD TRAIL—Cook and Will Counties

DIRECTIONS

Visitors can enter the Trail off any cross road and, in most places, can park cars on the road shoulder. Good parking and picnic areas connect with the Trail at Hickory Street Junction and Governors Trail Park on the north side of the Trail, east of Cicero Avenue in Matteson.

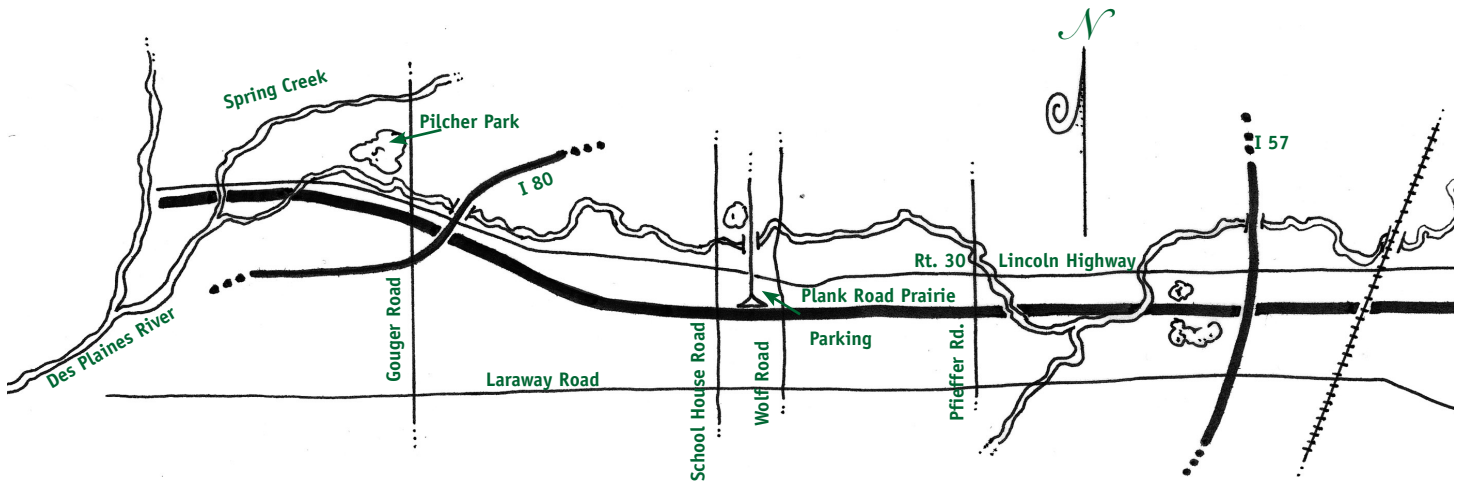

Map by Lynda Wallis

© 2000 Chicago Wilderness Magazine, Inc. www.chicagowildernessmag.org